



210115000-2022

m MINNESOTA POLLUTION CONTROL AGENCY

520 Lafayette Road North
St. Paul, MN 55155-4194

Compliance inspection report form

Existing Subsurface Sewage Treatment System (SSTS)

Doc Type: Compliance and Enforcement

Instructions: Inspector must submit completed form to Local Governmental Unit (LGU) and system owner within 15 days of final determination of compliance or noncompliance. Instructions for filling out this form are located on the Minnesota Pollution Control Agency (MPCA) website at <https://www.pca.state.mn.us/sites/default/files/wq-wwists4-31a.pdf>.

Property information

Local tracking number: _____

Parcel ID# or Sec/Twp/Range: 21.0115.000 Reason for Inspection Lake Survey

Local regulatory authority info: Becker County ESO

Property address: 24975 Washington Dr Osage MN 56570

Owner/representative: Michael Clark & Thomas Slover Owner's phone: _____

Brief system description: 1000/500 precast 2 - compartment tank, to 120 Lnft of SB-2 gravelless pipe drainfield.

System status

System status on date (mm/dd/yyyy): 7/12/2022

Compliant – Certificate of compliance*

Noncompliant – Notice of noncompliance

(Valid for 3 years from report date unless evidence of an imminent threat to public health or safety requiring removal and abatement under section 145A.04, subdivision 8 is discovered or a shorter time frame exists in Local Ordinance.)

Systems failing to protect ground water must be upgraded, replaced, or use discontinued within the time required by local ordinance.

***Note: Compliance indicates conformance with Minn. R. 7080.1500 as of system status date above and does not guarantee future performance.**

An imminent threat to public health and safety (ITPHS) must be upgraded, replaced, or its use discontinued within ten months of receipt of this notice or within a shorter period if required by local ordinance or under section 145A.04 subdivision 8.

Reason(s) for noncompliance (check all applicable)

- Impact on public health (Compliance component #1) – *Imminent threat to public health and safety*
- Tank integrity (Compliance component #2) – *Failing to protect groundwater*
- Other Compliance Conditions (Compliance component #3) – *Imminent threat to public health and safety*
- Other Compliance Conditions (Compliance component #3) – *Failing to protect groundwater*
- System not abandoned according to Minn. R. 7080.2500 (Compliance component #3) – *Failing to protect groundwater*
- Soil separation (Compliance component #5) – *Failing to protect groundwater*
- Operating permit/monitoring plan requirements (Compliance component #4) – *Noncompliant. Local ordinance applies*

Comments or recommendations

This system was installed on 5/23/96, with an estimated design flow of 200 gpd. Note: This system was inspected for compliance in 2012, with no issues reported. See additional notes on pages 2-4.

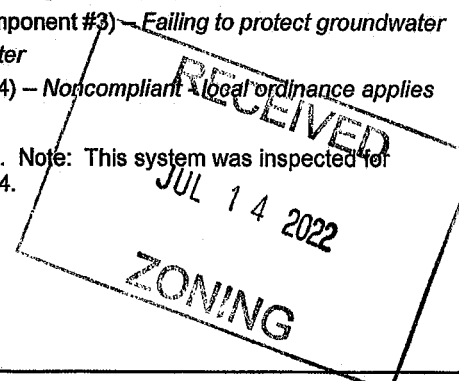

Certification

I hereby certify that all the necessary information has been gathered to determine the compliance status of this system. No determination of future system performance has been nor can be made due to unknown conditions during system construction, possible abuse of the system, inadequate maintenance, or future water usage.

By typing my name below, I certify the above statements to be true and correct, to the best of my knowledge, and that this information can be used for the purpose of processing this form.

Business name: Winterberger Inspections

Certification number: 3433

Inspector signature:

License number: 1565

(This document has been electronically signed)

Phone: 218-255-1722

Necessary or locally required supporting documentation (must be attached)

- Soil observation logs
- System/As-Built
- Locally required forms
- Tank Integrity Assessment
- Operating Permit
- Other information (list): _____

Property Address: 24975 Washington Dr Osage MN 56570

Business Name: Winterberger Inspections

Date: 7/12/2022

1. Impact on public health – Compliance component #1 of 5

Compliance criteria:

System discharges sewage to the ground surface	<input type="checkbox"/> Yes* <input checked="" type="checkbox"/> No
System discharges sewage to drain tile or surface waters.	<input type="checkbox"/> Yes* <input checked="" type="checkbox"/> No
System causes sewage backup into dwelling or establishment.	<input type="checkbox"/> Yes* <input checked="" type="checkbox"/> No

Attached supporting documentation:

- Other: _____
- Not applicable

Any "yes" answer above indicates the system is an imminent threat to public health and safety.

Describe verification methods and results:

This system was in use at time of inspection. No issues with the drainfield were observed, and the home owner had stated there have been no issues with system performance.

2. Tank integrity – Compliance component #2 of 5

Compliance criteria:

System consists of a seepage pit, cesspool, drywell, leaching pit, or other pit?	<input type="checkbox"/> Yes* <input checked="" type="checkbox"/> No
Sewage tank(s) leak below their designed operating depth?	<input type="checkbox"/> Yes* <input checked="" type="checkbox"/> No
If yes, which sewage tank(s) leaks:	

Attached supporting documentation:

- Empty tank(s) viewed by inspector
- Name of maintenance business: Kountry Kare Septic
- License number of maintenance business: 2517
- Date of maintenance: 7/12/2022
- Existing tank integrity assessment (Attach)
- Date of maintenance (mm/dd/yyyy): _____ (must be within three years)
- (See form instructions to ensure assessment complies with Minn. R. 7082.0700 subp. 4 B (1))*
- Tank is Noncompliant (pumping not necessary – explain below)
- Other: _____

Any "yes" answer above indicates the system is failing to protect groundwater.

Describe verification methods and results:

Normal liquid levels were observed in the tank prior to pump out. Both compartment manhole covers were dug up, the tank was pumped & cleaned, and no evidence of cracks were observed. Note: New risers & lids are to be installed.

Property Address: 24975 Washington Dr Osage MN 56570

Business Name: Winterberger Inspections

Date: 7/12/2022

3. Other compliance conditions – Compliance component #3 of 5

3a. Maintenance hole covers appear to be structurally unsound (damaged, cracked, etc.), or unsecured?

Yes* No Unknown

3b. Other issues (electrical hazards, etc.) to immediately and adversely impact public health or safety? Yes* No Unknown

**Yes to 3a or 3b - System is an imminent threat to public health and safety.*

3c. System is non-protective of ground water for other conditions as determined by inspector? Yes* No

3d. System not abandoned in accordance with Minn. R. 7080.2500? Yes* No

**Yes to 3c or 3d - System is falling to protect groundwater.*

Describe verification methods and results:

Attached supporting documentation: Not applicable

4. Operating permit and nitrogen BMP* – Compliance component #4 of 5 Not applicable

Is the system operated under an Operating Permit? Yes No **If "yes", A below is required**

Is the system required to employ a Nitrogen BMP specified in the system design? Yes No **If "yes", B below is required**

BMP = Best Management Practice(s) specified in the system design

If the answer to both questions is "no", this section does not need to be completed.

Compliance criteria:

a. Have the operating permit requirements been met? Yes No

b. Is the required nitrogen BMP in place and properly functioning? Yes No

Any "no" answer indicates noncompliance.

Describe verification methods and results:

Attached supporting documentation: Operating permit (Attach)

Property Address: 24975 Washington Dr Osage MN 56570

Business Name: Winterberger Inspections

Date: 7/12/2022

5. Soil separation – Compliance component #5 of 5

Date of installation 5/23/1996 Unknown
(mm/dd/yyyy)

Shoreland/Wellhead protection/Food beverage lodging? Yes No

Attached supporting documentation:

- Soil observation logs completed for the report
- Two previous verifications of required vertical separation
- Not applicable (No soil treatment area)
- _____

Compliance criteria (select one):

5a. For systems built prior to April 1, 1996, and not located in Shoreland or Wellhead Protection Area or not serving a food, beverage or lodging establishment: Yes No*

Drainfield has at least a two-foot vertical separation distance from periodically saturated soil or bedrock.

5b. Non-performance systems built April 1, 1996, or later or for non-performance systems located in Shoreland or Wellhead Protection Areas or serving a food, beverage, or lodging establishment: Yes No*

Drainfield has a three-foot vertical separation distance from periodically saturated soil or bedrock.*

5c. "Experimental", "Other", or "Performance" systems built under pre-2008 Rules; Type IV or V systems built under 2008 Rules 7080.2350 or 7080.2400 (Intermediate Inspector License required ≤ 2,500 gallons per day; Advanced Inspector License required > 2,500 gallons per day) Yes No*

Drainfield meets the designed vertical separation distance from periodically saturated soil or bedrock.

Indicate depths or elevations

A. Bottom of distribution media	35in.
B. Periodically saturated soil/bedrock	> 75in.
C. System separation	40in.
D. Required compliance separation*	36in.

*May be reduced up to 15 percent if allowed by Local Ordinance.

***Any "no" answer above indicates the system is failing to protect groundwater.**

Describe verification methods and results:

Upgrade requirements: (Minn. Stat. § 115.55) An imminent threat to public health and safety (ITPHS) must be upgraded, replaced, or its use discontinued within ten months of receipt of this notice or within a shorter period if required by local ordinance. If the system is failing to protect ground water, the system must be upgraded, replaced, or its use discontinued within the time required by local ordinance. If an existing system is not failing as defined in law, and has at least two feet of design soil separation, then the system need not be upgraded, repaired, replaced, or its use discontinued, notwithstanding any local ordinance that is more strict. This provision does not apply to systems in shoreland areas, Wellhead Protection Areas, or those used in connection with food, beverage, and lodging establishments as defined in law.

Boring 1 Elevation: Location: 21.01150:00 Depth to system bottom = 35in				
Soil Horizons Depth (inches)	Texture	Color	Structure	Consistence
0-5	fine sandy loam	10yr 3/2	granular	friable
5-34	med sand	10yr 4/6	single grain	loose
34-75	med sand	10yr 5/6	single grain	loose

Boring 2 Elevation: Location:				
Soil Horizons Depth (inches)	Texture	Color	Structure	Consistence

Boring 3 Elevation: Location:				
Soil Horizons Depth (inches)	Texture	Color	Structure	Consistence

Boring 4 Elevation: Location:				
Soil Horizons Depth (inches)	Texture	Color	Structure	Consistence

2012

21.0115.000

Site Evaluation Map

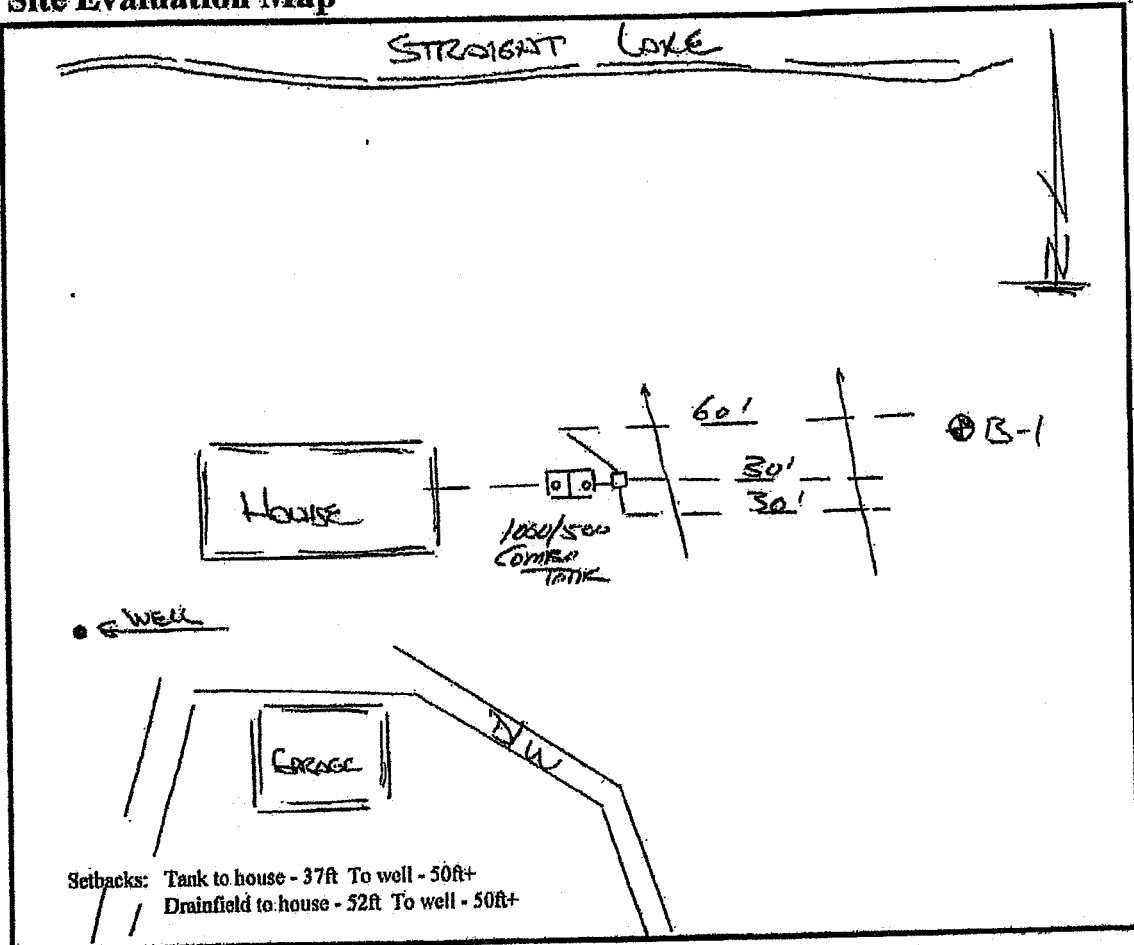

List any compliance issues: 21.01150.00 No issues. I would recommend installing tank manhole risers on both compartment for ease of tank maintenance.

Mapping Checklist

Map scale: N/A indicate north show slope % direction

Locate		Easements	Setbacks
<input type="checkbox"/>	lot dimensions/property lines	<input type="checkbox"/> phone	<input checked="" type="checkbox"/> building
<input checked="" type="checkbox"/>	dwellings and other improvements	<input type="checkbox"/> electric	<input checked="" type="checkbox"/> all water wells within 100ft
<input checked="" type="checkbox"/>	existing and/or proposed system(s)	<input type="checkbox"/> gas	<input type="checkbox"/> pressure pipe
<input type="checkbox"/>	replacement area		<input type="checkbox"/> water suction pipe
<input type="checkbox"/>	unsuitable area(s)		<input checked="" type="checkbox"/> streams, lakes, rivers
<input type="checkbox"/>	public water supply wells	<input checked="" type="checkbox"/> borings	<input type="checkbox"/> floodway and fringe
<input type="checkbox"/>	pumping access	<input type="checkbox"/> benchmark	
<input type="checkbox"/>	inner wellhead zone	<input type="checkbox"/> perc tests	
		<input type="checkbox"/> horiz&vert reference pts	

I hereby certify this work has been completed in accordance with all applicable ordinances, rules and laws.

[Signature] (signature) 7/12/22 (date)

1565 (license #) 218-573-2275 (phone number)